



Austworld Commodities Pty Ltd

PRODUCT APPRAISAL REPORT 1601 Issue 5

LOGI CIVIL Mechanical Compression Joint Brass Fittings for PE Pipes

AS/NZS 4129:2020 Fittings for polyethylene (PE) pipes for pressure applications

Issue 1 Published: 29 June 2016

Issue 2 Published: 12 December 2017

Issue 3 Published: 4 April 2018

Issue 4 Publication: 19 January 2021

Issue 5 Publication: 6 September 2021

Document History

The following information indicates the changes made to this document.

Date	Version
6 June 2016	Peer Review
29 June 2016	Issue 1 Publication
12 December 2017	Issue 2 Publication
2 April 2018	Issue 3 Client Review
4 April 2018	Issue 3 Publication
19 January 2021	Issue 4 Client Review
19 January 2012	Issue 4 Publication
6 September 2021	Issue 5 Client Review
6 September 2021	Issue 5 Publication

Peer Reviewers

Name/Title	Organisation	Date
Product Appraisal Technical Advisory Group	WSAA	28 June 2016
WSAA Expert Panel	WSAA	21 June 2016
Peter Pittard, WSAA Consultant	WSAA	1 December 2017
Carl Radford, Product Appraisal Manager	WSAA	12 December 2017
Peter Pittard, WSAA Consultant	WSAA	11 March 2018
Carl Radford, Product Appraisal Manager	WSAA	3 April 2018
Peter Pittard, WSAA Consultant	WSAA	18 January 2021
Carl Radford, Product Appraisal Manager	WSAA	19 January 2021
Peter Pittard, WSAA Consultant	WSAA	3 September 2021
Carl Radford, Product Appraisal Manager	WSAA	6 September 2021

Overview of WSAA

The Water Services Association of Australia (WSAA) is the peak industry body representing the urban water industry. Our members provide water and sewerage services to over 20 million customers in Australia and New Zealand and many of Australia's largest industrial and commercial enterprises.

Based around our vision of 'customer driven, enriching life', WSAA facilitates collaboration, knowledge sharing, networking and cooperation within the urban water industry. We are proud of the collegiate attitude of our members which has led to industry-wide approaches to national water issues.

WSAA can demonstrate success in the standardisation of industry performance monitoring and benchmarking, as well as many research outcomes of national significance. The WSAA Executive retains strong links with policy makers and legislative bodies and their influencers, to monitor emerging issues of importance to the urban water industry.

WSAA was formed in 1995 as a non-profit organisation to foster the exchange of information between industry, government and the community, and to promote sustainable water resource management.

The urban water industry is committed to anchoring its services to customers' values, and to enrich communities where water services have broad economic, environmental and social values. In line with this our main activities focus on four areas:

1. influencing national and state policies on the provision of urban water services and sustainable water resource management
2. promoting debate on environmentally sustainable development and management of water resources and the community health requirements of public water supplies
3. improving industry performance and establishing benchmarks and industry leading practices for water service processes; and
4. fostering the exchange of information on education, training, research, water and wastewater management and treatment and other matters of common interest.

Copyright

This document is copyrighted. Apart from any use as permitted under the Copyright Act 1968, no part of this document may be reproduced or transmitted in any form or by any means, electronically or mechanical, for any purpose, without the express written permission of Water Services Association of Australia Limited.

© Copyright 2021 by WATER SERVICES ASSOCIATION of Australia Limited **All rights reserved.**

CONTENTS

1 EXECUTIVE SUMMARY	5
1.1 Recommendations	5
2 THE APPLICANT.....	5
2.1 The Supplier.....	5
2.2 The Manufacturer.....	5
3 THE PRODUCT	5
4 SCOPE OF THE APPRAISAL.....	6
5 APPRAISAL CRITERIA.....	9
5.1 General	9
5.2 Quality Assurance Requirements	9
5.3 Performance Requirements	9
6 COMPLIANCE WITH APPRAISAL CRITERIA.....	10
6.1 Compliance with Quality Assurance Requirements	10
6.2 Compliance with Performance Requirements.....	10
6.2.1 Performance Tests	10
6.2.2 Suitability for contact with drinking water	10
6.2.3 Material requirements.....	10
7 FITTING INSTRUCTIONS, TRAINING AND INSTALLATION	11
8 PRODUCT MARKING	11
9 PACKAGING AND TRANSPORTATION.....	11
10 PRODUCT WARRANTY	11
11 WATER AGENCY EXPERIENCE WITH THE PRODUCT OR FIELD TESTING REPORT	11
12 OUTCOMES OF EXPERT PANEL REVIEW.....	11
13 FUTURE WORKS.....	11
14 DISCLAIMER.....	11
14.1 Issue of Report.....	12
14.2 Limits on Reliance on Information and Recommendations.....	12
14.2.1 Disclaimer of liability.....	12
14.2.2 Intellectual Property and other rights.....	12
14.2.3 Need for independent assessment.....	12
14.3 No Updating	13
14.4 No Warranty.....	13
APPENDIX A – TECHNICAL MANUAL/BROCHURES.....	14
APPENDIX B – QUALITY CERTIFICATIONS.....	27
APPENDIX C – SUPPLIER CONTACTS	31

1 EXECUTIVE SUMMARY

Austworld Commodities Pty Ltd is an Australian based stockist and distributor of plumbing and drainage products with distribution centres in Melbourne, Gold Coast, Adelaide and Sydney. Austworld was established in 1987 and also services Asia, Europe and the Middle East with its range of plumbing products. Logi Dezin is a trading name of Austworld.

This appraisal is for a range of LOGI CIVIL brass compression fittings for use with polyethylene (PE) pipes. The fittings are manufactured in the Peoples Republic of China (PRC) to AS/NZS 4129:2020 *Fittings for polyethylene (PE) pipes for pressure applications*.

The fittings consist of unions, elbows and pipe stands all incorporating a DN 25 or DN 32 PE compatible mechanical compression joint with male thread, female thread or copper capillary end connections. The range of PN 16 rated fittings is detailed in Section 4.

This Issue 5 is a replacement for the previous version of the appraisal which had reached its 5-year expiry date. Additional products have also been added to the range: AW4202, AW4216 and FP20.

The manufacturer has a quality management system certified to ISO 9001:2015.

The fittings have ISO Type 5 product certification to AS/NZS 4129:2020 *Fittings for polyethylene (PE) pipes for pressure applications*.

This Appraisal has determined that the brass fittings for PE pipe as detailed in this report, meet the requirements of WSA PS 247 *Metallic Bodied Mechanical Compression Joint Fittings for Pressure Applications with Polyethylene (PE) Pipe – Water Supply and Sewerage* and are considered as 'fit-for-purpose'.

1.1 Recommendations

It is recommended that WSAA members accept/authorise LOGI CIVIL brass mechanical compression joint fittings for PE pipes as detailed in this Appraisal, for applications in water supply pressure pipelines provided they are installed in accordance with WSAA Codes and the manufacturer's requirements, where specified.

2 THE APPLICANT

The Applicant is Austworld Commodities Pty Ltd.

2.1 The Supplier

Austworld is an Australian based stockist and distributor of plumbing and drainage products with distribution centres in Melbourne, Gold Coast, Adelaide and Sydney. Austworld was established in 1987 and also services Asia, Europe and the Middle East with its range of plumbing products. Logi Dezin is a trading name of Austworld.

2.2 The Manufacturer

The fittings included in this Appraisal are manufactured in China by a joint venture company partly owned and operated by Austworld. The name and location of the manufacturing plant has been requested to remain commercial-in-confidence, however a copy of the relevant and current ISO 9001 licence has been submitted for this Appraisal.

3 THE PRODUCT

LOGI CIVIL brass mechanical compression joint fittings for use with polyethylene (PE) pipes are manufactured by Logi Dezin in accordance with AS/NZS 4129:2020 *Fittings for polyethylene (PE) pipes for pressure applications*.

The fittings submitted for this Appraisal consist of unions, elbows and pipe stands all incorporating a DN 25 or DN 32 PE compatible compression joint with male thread, female thread or copper capillary end connections. The range of PN 16 rated fittings is detailed in Section 4.

Austworld confirms that the PE joint design is suitable for PN 12.5 and PN 16 PE 100 pipe to AS/NZS 4130. The design of the joint incorporates a positive stop which prevents over tightening.

Data Sheets for the LOGI CIVIL compression fittings are provided in Appendix A.

4 SCOPE OF THE APPRAISAL

The fittings included in this appraisal are detailed in Tables 1 to 9.

**TABLE 1
PE – MALE THREAD UNIONS**

Product Code	DN	End Connections
AW4200	25-20	PE to Male Thread
AW4203	25-25	PE to Male Thread
AW4204	32-25	PE to Male Thread

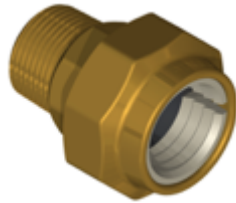

FIGURE 1 PE TO MALE THREAD UNION

**TABLE 2
PE – FEMALE THREAD UNIONS**

Product Code	DN	End Connections
AW4205	25-20	PE to Female Thread
AW4206	32-25	PE to Female Thread
MCPE2025	25-20	PE to Female Thread – Swivel joint for meter



FIGURE 2 PE TO FEMALE THREAD UNION

**TABLE 3
PE – PE UNION**

Product Code	DN	End Connections
AW4210	25-25	PE - PE
AW4213	32-25	PE - PE
AW4214	32-32	PE - PE



FIGURE 3 PE TO PE UNION

**TABLE 4
PE – COPPER CAPILLARY UNIONS**

Product Code	DN	End Connections
AW4208	25-20	PE - Cu Capillary
AW4209	32-25	PE - Cu Capillary



FIGURE 4 PE TO COPPER CAPILLARY UNION

**TABLE 5
PE – MALE THREAD ELBOW**

Product Code	DN	End Connections
AW4202	25-20	PE to Male Thread



FIGURE 5 PE TO MALE THREAD ELBOW

**TABLE 6
PE – FEMALE THREAD ELBOW**

Product Code	DN	End Connections
AW4201	25-20	PE – Female Thread
AW4207	32-25	PE – Female Thread
FP20	25-25	PE to Female Thread – Swivel joint for meter



FIGURE 6 PE TO FEMALE THREAD ELBOW

**TABLE 7
PE – PE ELBOW**

Product Code	DN	End Connections
AW4211	25-25	PE – PE
AW4215	32-32	PE – PE



FIGURE 7 PE TO PE ELBOW

**TABLE 8
PE TO COPPER CAPILLARY ELBOW**

Product Code	DN	End Connections
AW4216	25-20	PE - Cu Capillary



FIGURE 8 PE TO COPPER CAPILLARY ELBOW

**TABLE 9
PIPE STANDS**

Product Code	DN	End Connections
SB2520	25-20	PE – Female Thread (S Pipe)
JP2532	32-25	PE – Male Thread (J Pipe)

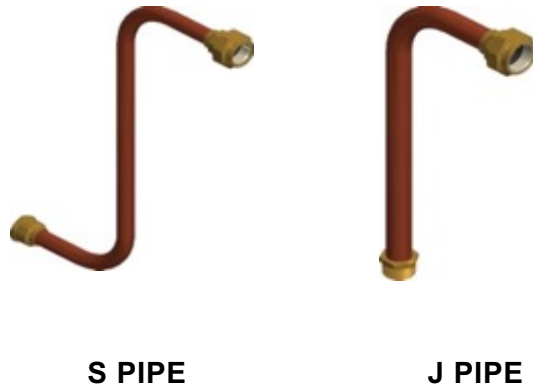

FIGURE 9 PE PIPE STANDS

5 APPRAISAL CRITERIA

5.1 General

Appraisal criteria is determined by the WSAA Product Appraisal Technical Advisory Group and regularly reviewed to ensure that the criteria reflect the requirements of WSAA members.

5.2 Quality Assurance Requirements

The WSAA Product Appraisal Technical Advisory Group accepts brass compression fittings for PE pipes manufactured in compliance with AS/NZS 4129:2020 *Fittings for polyethylene (PE) pipes for pressure applications* and duly certified by means of an ISO Type 5 product certification scheme undertaken by a JAS-ANZ accredited Conformity Assessment Body (CAB) or by an International accreditation system recognised by JAS-ANZ.

The manufacturer is generally expected to have a production management and control system that has been duly accredited in accordance with AS/NZS ISO 9001 as a prerequisite to undergoing a product certification audit.

The ISO Type 5 Product Certification Scheme shall meet the criteria described in WSA TN-08.

5.3 Performance Requirements

LOGI CIVIL brass compression fittings have been appraised for compliance with AS/NZS 4129:2020 *Fittings for polyethylene (PE) pipes for pressure applications*.

Appraisal criteria are also determined by the WSAA Product Appraisal Technical Advisory Group and regularly reviewed to ensure that the criteria reflect the requirements of WSAA members.

The following Product Specification is also relevant to this application:

WSA PS 247 *Metallic Bodied Mechanical Compression Joint Fittings for Pressure Applications with Polyethylene (PE) Pipe – Water Supply and Sewerage*

A copy of the Product Specification is available at the following link:

<https://www.wsaa.asn.au/shop/product/35716>

6 COMPLIANCE WITH APPRAISAL CRITERIA

6.1 Compliance with Quality Assurance Requirements

Austworld has submitted the following quality certificates:

- ISO 9001:2015 Certificate of Registration issued to Austworld's Chinese based manufacturing plant, issued by Zhejiang Quanpin Certification Co Ltd, a body accredited by CNAS. Austworld has requested that the name of their manufacturing plant remain commercial-in-confidence.
- AS/NZS 4129:2020 ISO Type 5 product certification Licence No. 3019 issued to Logi Deziqn by Australian Certification Services Pty Ltd.

6.2 Compliance with Performance Requirements

6.2.1 Performance Tests

Austworld has provided type test results for a DN 25 PE – DN 20 male thread union to demonstrate compliance to the performance requirements of AS/NZS 4129. Prove Standards and Engineering Pty Ltd, NATA Accredited Laboratory No. 18640, conducted the tests on the brass fitting.

Tests conducted on the joints included hydrostatic pressure test, infiltration test, leak-tightness when subjected to bending and pull-out test. Tests were conducted in accordance with the PN 16 rating of the fitting.

A test report has also been submitted for PN 25 and PN 32 PE compatible compression joints to demonstrate suitability with PN 12.5 pipe. A leak tightness test when subjected to bending and a pull-out test were successfully completed by Prove Standards and Engineering Pty Ltd in accordance with AS/NZS 4129.

6.2.2 Suitability for contact with drinking water

Austworld has submitted Test Report No. SM-ST200030 from Standardmark Laboratory Sdn Bhd (Standards Malaysia Accreditation No.786) dated 20th November 2020 for a DN 20 ball valve manufactured from the same material as the fittings. This report has been accepted to demonstrate compliance with AS/NZS 4020:2018.

6.2.3 Material requirements

The material specifications for the components of the brass fittings are given in Table 6.

All copper alloy components are manufactured from EN 12164 Grade CW602N. This alloy is a leaded arsenical brass (CuZn36Pb2As) listed as a Category 1 alloy in AS 2345 and is approximately equivalent to Grade C35200 of AS/NZS 1567. Test certificates have been submitted to demonstrate material compliance and dezincification resistance to AS 2345.

TABLE 6 COMPONENTS MATERIAL LIST

Component	Material	Standard	Grade
Body	Copper Alloy	EN 12164	CW602N
Nut	Copper Alloy	EN 12164	CW602N
Seal	Elastomeric	AS1646	EPDM
Retaining Ring	Polymer	-	-

7 FITTING INSTRUCTIONS, TRAINING AND INSTALLATION

Brass fittings are standard water industry products. General specification information is shown in the data sheets in Appendix A.

8 PRODUCT MARKING

The LOGI CIVIL brass fittings have the following markings:

- Manufacturer's name or trademark – LD
- Nominal size – DN 25, DN32
- Allowable Operating Pressure – PN16

9 PACKAGING AND TRANSPORTATION

The fittings are packed into a plastic bag which are then packed into cardboard cartons for transportation.

10 PRODUCT WARRANTY

The products are covered by the normal commercial and legal requirements of the Competition and Consumer Act 2010 (Cth), which covers manufacture to the relevant standard, and details of Austworld's warranty is included in their terms and conditions of sale.

11 WATER AGENCY EXPERIENCE WITH THE PRODUCT OR FIELD TESTING REPORT

Brass fittings are considered standard products and installation trials were not required as part of this Appraisal.

12 OUTCOMES OF EXPERT PANEL REVIEW

No issues have been raised.

13 FUTURE WORKS

No future works have been identified.

14 DISCLAIMER

This Product Appraisal Report (Report) is issued by the Water Services Association of Australia Limited on the understanding that:

This Report applies to the product(s) as submitted. Any changes to the product(s) either minor or major shall void this Report.

To maintain the recommendations of this Report any such changes shall be detailed and notified to the Product Appraisal Manager for consideration and review of the Report and appropriate action. Appraisals and their recommendations will be the subject of continuous review dependent upon the satisfactory performance of products.

WSAA reserves the right to undertake random audits of product manufacture and installation. Where products fail to maintain appraised performance requirements the appraisal and its recommendations may be modified and reissued. Appraisal reports will be reviewed and reissued at regular intervals not exceeding five (5) years.

The following information explains a number of very important limits on your ability to rely on the information in this Report. Please read it carefully and take it into account when considering the contents of this Report.

Any enquiries regarding this report should be directed to the Program Manager, Carl Radford, Phone: 03 8605 7601 email carl.radford@wsaa.asn.au.

14.1 Issue of Report

This Report has been published and/or prepared by the Water Services Association of Australia Limited and nominated Project Manager and peer group of technical specialists (the Publishers).

The Report has been prepared for use within Australia only by technical specialists that have expertise in the function of products such as those appraised in the Report (the Recipients).

By accepting this Report, the Recipient acknowledges and represents to the Publisher(s) and each person involved in the preparation of the Report that the Recipient has understood and accepted the terms of this Disclaimer.

14.2 Limits on Reliance on Information and Recommendations

14.2.1 Disclaimer of liability

Neither the Publisher(s) nor any person involved in the preparation of the Report accept(s) any liability for any loss or damage suffered by any person however caused (including negligence or the omission by any person to do anything) relating in any way to the Report or the product appraisal criteria underlying it. This includes (without limitation) any liability for any recommendation or information in the Report or any errors or omissions.

14.2.2 Intellectual Property and other rights

The Water Services Association of Australia Limited does not undertake any assessment of whether the importation, manufacture, sale or use of the Product the subject of this Report infringes the intellectual property rights or proprietary rights of any person. Recipients of the report should undertake their own assessment of whether (as relevant) the importation, manufacture, sale or use of the relevant Products infringe the intellectual property rights or other proprietary rights of any person. If the Product infringes intellectual property rights or other proprietary rights there is potential for the supply of the Products to be interrupted.

From time to time the Water Services Association of Australia Limited and the other Publishers may receive notice of allegations that the importation, manufacture, sale or use of the Product infringes intellectual property rights or other proprietary rights. The Water Services Association of Australia Limited's policy is to not refer to such allegations in its reports or take any other steps to put Recipients on notice of such allegations, unless and until it is aware that the allegations have been admitted or proved in Court. As such, Recipients acknowledge, agree and accept that the Water Services Association of Australia Limited may have information in its possession about intellectual property rights infringement allegations or other infringement allegations in relation to the Product which are not referred to or disclosed in this Report and which are not otherwise communicated to Recipients.

14.2.3 Need for independent assessment

The information and any recommendation contained (expressly or by implication) in this Report are provided in good faith (and subject to the limitations noted in this Report). However, you should treat the information as indicative only. You should not rely on that information or any such recommendation except to the extent that you reach an agreement to the contrary with the Publisher(s).

This Report does not contain all information that a person might require for the purposes of assessing any product discussed or appraised within it (Product). The product appraisal criteria used in preparing this Report may not address all relevant aspects of the Product.

Recipients should seek independent evidence of any matter which is material to their decisions in connection with an assessment of the Product and consult their own advisers for any technical information required. Any decision to use the Product should take into account the reliability of that independent evidence obtained by the Recipient regarding the Product.

Recipients should also independently verify and assess the appropriateness of any recommendation in the Report, especially given that any recommendation will not take into account a Recipient's particular needs or circumstances.

WSAA has not evaluated the extent of the product liability and professional indemnify insurance that the provider of the product maintains. Recipients should ensure that they evaluate the allocation of liability for product defects and any professional advice obtained in relation to the product or its specification including the requirements for product liability and professional indemnity insurance.

14.3 No Updating

Neither the Publisher(s) nor any person involved in the preparation of this Report [has] [have] any obligation to notify you of any change in the information contained in this Report or of any new information concerning the Publisher(s) or the Product or any other matter.

14.4 No Warranty

The Publisher(s) do[es] not, in any way, warrant that steps have been taken to verify or audit the accuracy or completeness of the information in this Report, or the accuracy, completeness or reasonableness of any recommendation in this Report.

APPENDIX A – TECHNICAL MANUAL/BROCHURES



**POLY CONNECTOR
UNION PE X MI**

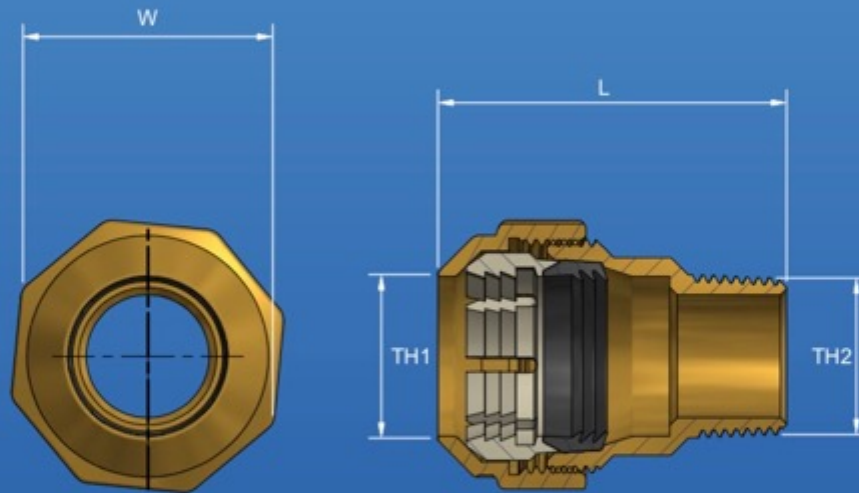

Sizing Chart MM

	L	W	TH1	TH2
AW4200	57	41	25PE	R 3/4"
AW4203	60	43	25PE	R 1"
AW4204	60	50	32PE	R 1"



Austworld
PO Box 311
Ashmore City
QLD 4214

P: 1300 780 430
F: 1300 780 441
E: info@austworld.com.au
W: www.austworld.com.au



REGULATED AS PART OF AUSTWORLD'S COMMITMENT TO QUALITY PRODUCTS, AUSTWORLD RESERVES THE RIGHT TO ALTER THE DESIGN OR SPECIFICATION OF ITS PRODUCT WITHOUT NOTICE. THE PRODUCT IMAGES SHOWN ARE FOR ILLUSTRATION PURPOSES ONLY AND MAY NOT BE AN EXACT REPRESENTATION OF THE PRODUCT.

Ver 1.0



POLY CONNECTOR UNION PE X FI

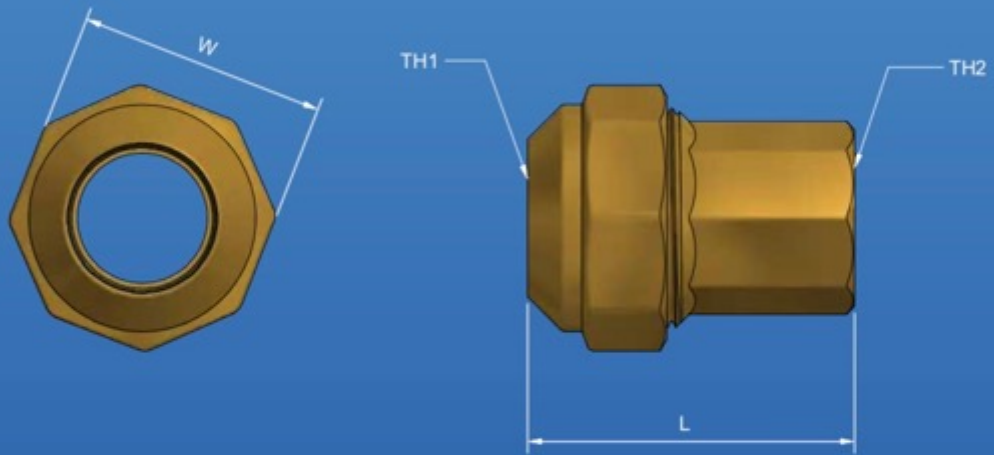

Sizing Chart MM

	L	W	TH1	TH2
AW4205	57	43	25PE	Rp 3/4"
AW4206	60	50	32PE	Rp 1"



Austworld
PO Box 311
Ashmore City
QLD 4214

P: 1300 780 430
F: 1300 780 441
E: info@austworld.com.au
W: www.austworld.com.au



POLY CONNECTORS

Meter Coupling Meter Thread Swivel Nut PE X FI

Product Specifications

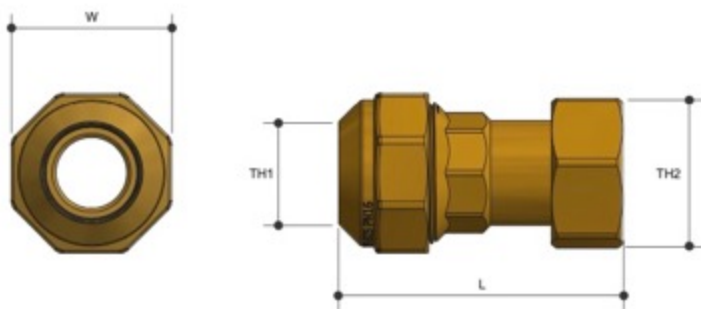

Specifications

Working temperature -20°C to 60°C

Max. pressure rating 1600kPa

Sizing Chart (MM)

	L	W	TH1	TH2
MCPE2025	76	43	DN25	20F1*

*Meter Thread QLD/VIC AS1722.2

Features

Watermark approved

DR Brass

100% pressure tested

No disassembly required, pipe can be inserted without disassembling the fitting

Triple lip seal

No fiddly thimbles or grab rings

Spare parts available

Tested and certified to AS 4796

Material Chart

Part	Material
Socket	DR Brass
Clamp Ring	POM Acetal Resin
Nut	DR Brass
Seal	EPDM

For more information on Logi Civil, contact:
 Austworld 15 Activity Crescent, Malendinar, Queensland 4214 Australia
 P. 1300 780 430 F. 1300 780 441 E. info@austworld.com.au

Austworld Pty Ltd. All rights reserved 2018.
 Austworld and Logi Civil are registered trade mark belonging to Austworld Pty Ltd.





POLY CONNECTOR UNION PE X PE

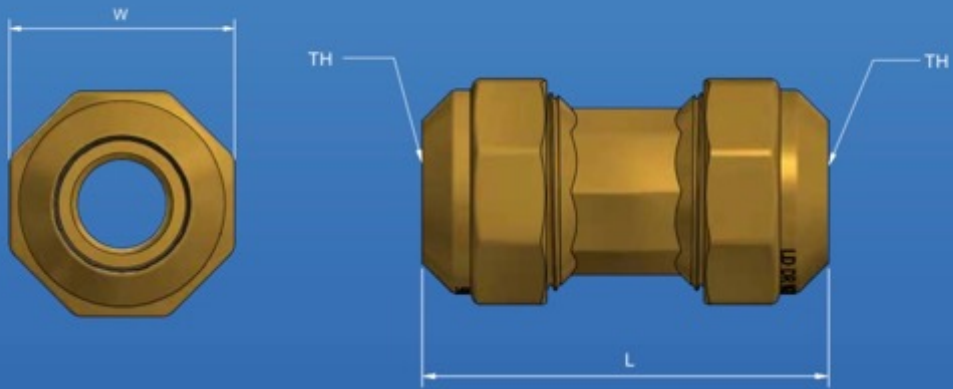

Sizing Chart MM

	L	W	TH
AWN210	78	43	25PE
AWN214	79	50	32PE



Austworld
PO Box 311
Ashmore City
QLD 4214

P: 1300 780 430
F: 1300 780 441
E: info@austworld.com.au
W: www.austworld.com.au



DISCLAIMER: AS PART OF AUSTWORLD'S COMMITMENT TO QUALITY PRODUCTS, AUSTWORLD RESERVES THE RIGHT TO ALTER THE DESIGN OR SPECIFICATION OF ITS PRODUCT WITHOUT NOTICE. THE PRODUCT IMAGES SHOWN ARE FOR ILLUSTRATION PURPOSES ONLY AND MAY NOT BE AN EXACT REPRESENTATION OF THE PRODUCT.

Ver 1.0



POLY CONNECTOR UNION PE X PE REDUCING

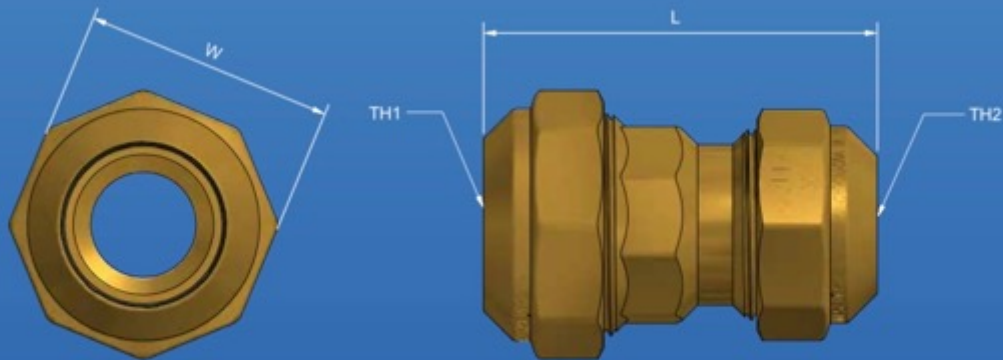

Sizing Chart MM

	L	W	TH1	TH2
AW4213	79	50	32PE	25PE



Austworld
PO Box 311
Ashmore City
QLD 4214

P: 1300 780 430
F: 1300 780 441
E: info@austworld.com.au
W: www.austworld.com.au



REGULATORY ASPECTS OF AUSTWORLD'S COMMITMENT TO QUALITY PRODUCTS. AUSTWORLD RESERVES THE RIGHT TO ALTER THE DESIGN OR SPECIFICATIONS OF ITS PRODUCT WITHOUT NOTICE. THE PRODUCT IMAGE SHOWN ARE FOR ILLUSTRATION PURPOSES ONLY AND MAY NOT BE AN EXACT REPRESENTATION OF THE PRODUCT.



POLY CONNECTOR UNION PE X CU CAPILLARY

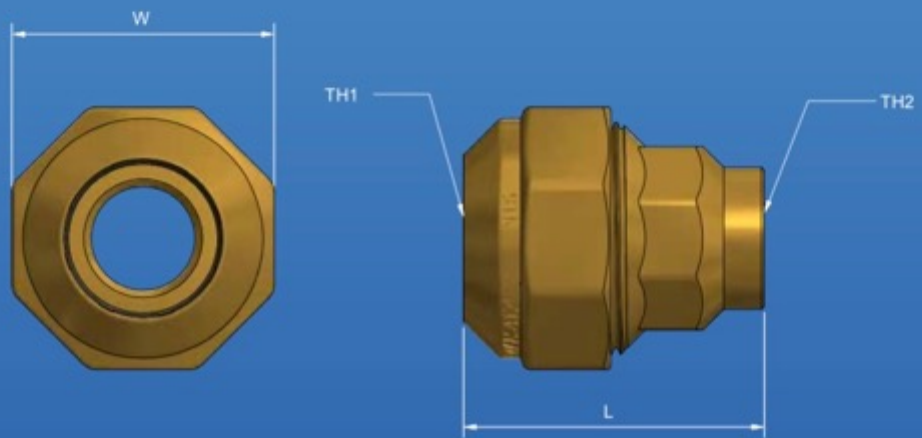

Sizing Chart MM

	L	W	TH1	TH2
AW4208	49	43	25PE	20CU
AW4209	50	50	32PE	25CU



Austworld
PO Box 311
Ashmore City
QLD 4214

P: 1300 780 430
F: 1300 780 441
E: info@austworld.com.au
W: www.austworld.com.au



DECLARATION BY PART OF AUSTWORLD COMMITMENT TO QUALITY PRODUCTS, AUSTWORLD RESERVES THE RIGHT TO ALTER THE DESIGN OR SPECIFICATION OF ITS PRODUCT WITHOUT NOTICE. THE PRODUCT DIMENSIONS AND QUALITY WILL BE THE RESPONSIBILITY OF THE USER. THESE DIMENSIONS ARE NOT AN EXACT REPRESENTATION OF THE PRODUCT.

POLY CONNECTORS

Elbow DN X MI

Product Specifications

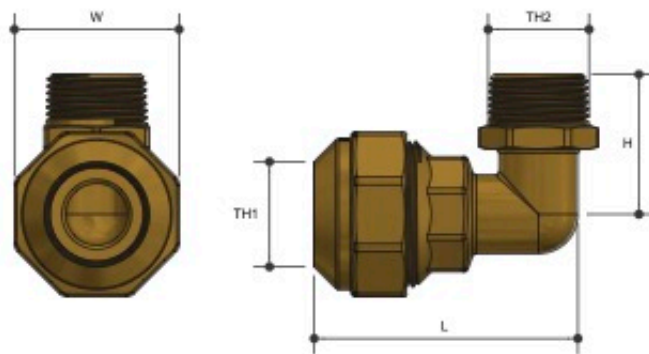

Specifications

Working temperature -20°C to 60°C
 Max. pressure rating 1600kPa

Sizing Chart (MM)

	L	H	W	TH1	TH2
AW4202	59	37	43	DN25	R 3/4"

Features

- Watermark approved
- DR Brass
- 100% pressure tested
- No disassembly required, pipe can be inserted without disassembling the fitting
- Triple lip seal
- No faly thimbles or grab rings
- Spare parts available
- Tested and certified to AS 4796

Material Chart

Part	Material
Socket	DR Brass
Clamp Ring	POM Acetal Resin
Nut	DR Brass
Seal	EPDM

For more information on Logi Civil, contact:
 Austworld 15 Activity Crescent, Molendinar, Queensland 4214 Australia
 P. 1300 780 430 F. 1300 780 441 E. info@austworld.com.au

Austworld Pty Ltd. All rights reserved 2018.
 Austworld and Logi Civil are registered trade mark belonging to Austworld Pty Ltd.





POLY CONNECTOR ELBOW PE X FI

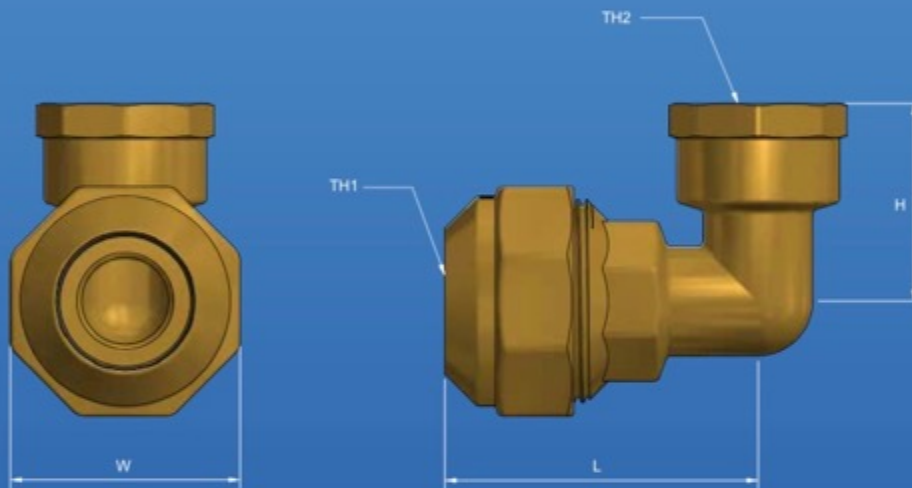

Sizing Chart MM

	L	H	W	TH1	TH2
AW4201	59	37	43	25PE	Rp 3/4"
AW4207	60	45	50	32PE	Rp 1"



Austworld
PO Box 311
Ashmore City
QLD 4214

P: 1300 780 430
F: 1300 780 441
E: info@austworld.com.au
W: www.austworld.com.au



FERRULE BENDS

DN

Product Specifications

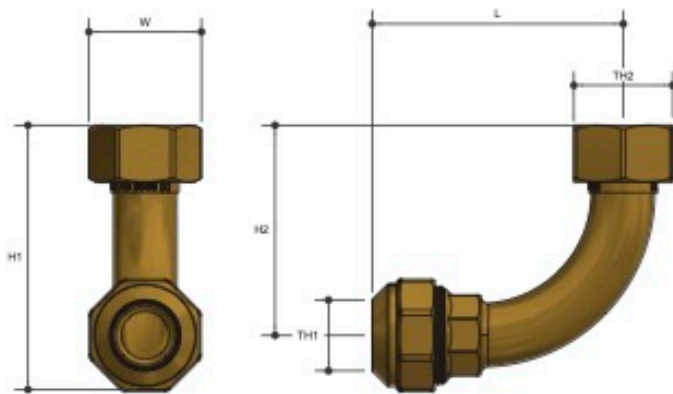

Specifications

Working temperature -20°C to 60°C
 Max. pressure rating 1600kPa

Sizing Chart (MM)

FP20	L	H1	H2	W	TH1	TH2
FP20	97	102	81	43	DN25	G 1"

Features

- Watermark approved
- DR Brass
- 100% pressure tested
- No disassembly required, pipe can be inserted without disassembling the fitting
- Triple lip seal
- No fiddy thimbles or grab rings
- Spare parts available
- Tested and certified to AS 3688

Material Chart

Part	Material
Seal	EPDM
Nut	DR Brass
Body	DR Brass
O Ring	PCM

For more information on Logi Civil, contact:
 Austworld 15 Activity Crescent, Molendinar, Queensland 4214 Australia
 P. 1300 780 430 F. 1300 780 441 E. info@austworld.com.au

Austworld Pty Ltd. All rights reserved 2018.
 Austworld and Logi Civil are registered trade mark belonging to Austworld Pty Ltd.





POLY CONNECTOR ELBOW PE X PE

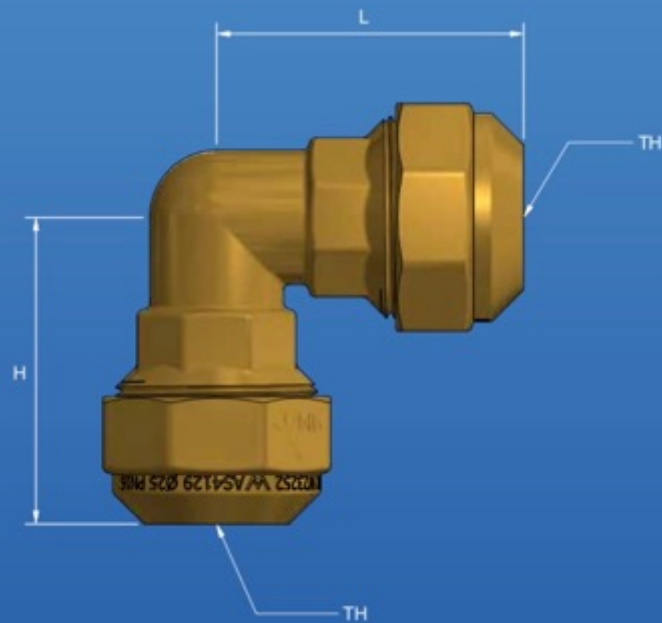

Sizing Chart MM

	L	H	TH
AW4211	58	58	25PE
AW4215	61	61	32PE



Austworld
PO Box 311
Ashmore City
QLD 4214

P: 1300 780 430
F: 1300 780 441
E: info@austworld.com.au
W: www.austworld.com.au



DECLARATION BY PART OF AUSTWORLD COMMITMENT TO QUALITY PRODUCTS: AUSTWORLD RESERVES THE RIGHT TO ALTER THE DESIGN OR SPECIFICATIONS OF ITS PRODUCTS WITHOUT NOTICE. THE PRODUCT IMAGES SHOWN ARE FOR ILLUSTRATION PURPOSES ONLY AND MAY NOT BE AN EXACT REPRESENTATION OF THE PRODUCT.

POLY CONNECTORS

Elbow DN X Capillary

Product Specifications

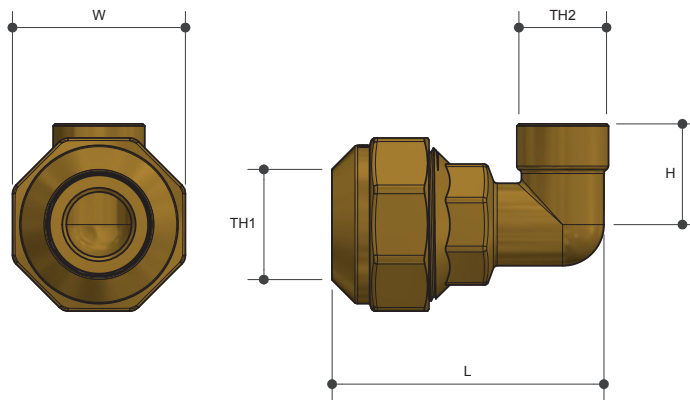

Specifications

Working temperature -20°C to 60°C

Max. pressure rating 1600kPa

Sizing Chart (MM)

	L	H	W	TH1	TH2
AW4216	68	25	43	20CU	DN25

Features

Watermark approved

DR Brass

100% pressure tested

No disassembly required, pipe can be inserted without disassembling the fitting

Triple lip seal

No fidly thimbles or grab rings

Spare parts available

Tested and certified to AS 4796

Material Chart

Part	Material
Seal	EPDM
Nut	DR Brass
Body	DR Brass
O Ring	POM

For more information on Logi Civil, contact:
 Austworld 15 Activity Crescent, Molendinar, Queensland 4214 Australia
 P. 1300 780 430 F. 1300 780 441 E. info@austworld.com.au

Austworld Pty Ltd. All rights reserved 2018.
 Austworld and Logi Civil are registered trade mark belonging to Austworld Pty Ltd.





PIPE STAND 20 CU 25 POLY X 20 FI

SB2520



Specifications

- Working temperature -20°C to 60°C
- Max. pressure rating 1600kPa

Features

- DR Brass
- Watermark approved
- No disassembly required, pipe can be inserted without disassembling the fitting
- Triple lip seal
- No fidly thimbles or grab rings
- Spare parts available



Austworld
PO Box 311
Ashmore City
QLD 4214

P: 1300 780 430
F: 1300 780 441
E: info@austworld.com.au
W: www.austworld.com.au





PIPE STAND J 25 CU POLY X 25 MI

JP2532

Specifications

- Working temperature -20°C to 60°C
- Max. pressure rating 1600kPa

Features

- DR Brass
- Watermark approved
- No disassembly required, pipe can be inserted without disassembling the fitting
- Triple lip seal
- No fidly thimbles or grab rings
- Spare parts available



Austworld
PO Box 311
Ashmore City
QLD 4214

P: 1300 780 430
F: 1300 780 441
E: info@austworld.com.au
W: www.austworld.com.au



DECLARATION BY AUSTWORLD COMMITMENT TO QUALITY PRODUCTS: AUSTWORLD RECEIVES THE RIGHT TO AUTHORISE THE SELECTION, PRODUCTION OF ITS PRODUCT WITHOUT NOTICE. THE PRODUCT IMAGES SHOWN ARE FOR INFORMATION PURPOSES ONLY AND MAY NOT BE AN EXACT REPRESENTATION OF THE PRODUCT.

Ver. 1.0

APPENDIX B – QUALITY CERTIFICATIONS

A copy of the following Quality Certification Certificate is available from WSAA.

TABLE B1 LOGI DEZIGN PTY LTD – PRODUCT CERTIFICATION

15 Activity Crescent Molendinar Qld	
Product Standard/Spec.	AS/NZS 4129:2020
Certificate No.	3019
Issuing Certification Body	Australian Certification Services Pty Ltd
First Date of Certification	17 December 2019
Current Date of Certification	27 August 2021
Expiry Date of Certification	16 December 2024



PRODUCT CONFORMITY SCHEME – FULL CERTIFICATION

Certification Licence

Australian Certification Services Pty Ltd grants to:

Logi Dezign

Trading as Logi Dezign

the right to use the Certification Mark as shown above in conjunction with the Certificate No. on product/s as identified in the Schedule and as listed on the Australian Certification Services Website www.certificationservices.com.au and have been shown to comply with the relevant Standard/s referred to below. The Licensee is granted a licence to use the Certification Mark subject to the rules governing the use.

Product Type: Fittings for use with Polyethylene (PE) Pipe to AS/NZS 4130
 Brand: LOGI CIVIL
 Evaluated to: AS/NZS 4129:2020 Fittings for polyethylene (PE) pipes for pressure applications

Issue Date: 27th August 2021
 Initial Issue Date: 17th December 2019
 Expiry Date: 16th December 2024

Paul Greig
 General Manager

Certificate No.: 3019

This certificate remains the property of Australian Certification Services Pty Ltd

The Product Conformity Scheme (PCS) – Full Certification is a conformity assessment scheme based on ISO/IEC 17067 (Scheme Type 5) and SA HB 18.28





Product Conformity Scheme (PCS)-FULL Certification Licence Schedule

Certificate Holder	Logi Dezn 15 Activity Crescent, Molendinar Qld 4214 Australia Website: www.austworld.com.au
Certificate Number	3019
Certification Standard/s:	AS/NZS 4129:2020 Fittings for polyethylene (PE) pipes for pressure applications

Product Listing

Model Identification	Brand Name	Product Description
AW4200	LOGI CIVIL	DN25 Copper Alloy (Brass DR) Adaptor DN25 x R3/4"
AW4201	LOGI CIVIL	DN25 Copper Alloy (Brass DR) Elbow Adaptor DN25 x RP3/4"
AW4202	LOGI CIVIL	DN25 Copper Alloy (Brass DR) Elbow Adaptor DN25 x R3/4"
AW4203	LOGI CIVIL	DN25 Copper Alloy (Brass DR) Adaptor DN25 x R1"
AW4204	LOGI CIVIL	DN32 x 25 Copper Alloy (Brass DR) Adaptor DN32 x R1"
AW4205	LOGI CIVIL	DN25 x 20 Copper Alloy (Brass DR) Adaptor DN25 x RP3/4"
AW4206	LOGI CIVIL	DN32 x 25 Copper Alloy (Brass DR) Adaptor DN32 x RP1"
AW4207	LOGI CIVIL	DN32 x DN25 Copper Alloy (Brass DR) Elbow Adaptor DN32 x R1"
AW4208	LOGI CIVIL	DN25 x 20 Copper Alloy (Brass DR) Adaptor DN25 x 20CU
AW4209	LOGI CIVIL	DN32 x 25 Copper Alloy (Brass DR) Adaptor DN32 x 25CU
AW4210	LOGI CIVIL	DN25 Copper Alloy (Brass DR) Straight Coupling DN25 x DN25
AW4211	LOGI CIVIL	DN25 Copper Alloy (Brass DR) Elbow DN25 x DN25
AW4213	LOGI CIVIL	DN32 x 25 Copper Alloy (Brass DR) Reducing Coupling DN32 x 25
AW4214	LOGI CIVIL	DN32 Copper Alloy (Brass DR) Straight Coupling DN32 x DN32
AW4215	LOGI CIVIL	DN32 Copper Alloy (Brass DR) Elbow DN32 x DN32
JP2532	LOGI CIVIL	DN32 x 25 Pipe Stand J Shape Adaptor DN32 x R1 Male Threaded



Model Identification	Brand Name	Product Description
MCPE2025	LOGI CIVIL	DN25x20 Copper Alloy (Brass DR) Adaptor DN25PE x RP3/4" Loose Nut
SB2520	LOGI CIVIL	DN25 x 20 Pipe Stand S Shape Adaptor DN25 x RP3/4 Female Threaded
AW4216	LOGI CIVIL	DN25x20 Copper Alloy (Brass DR) Elbow Adaptor DN25 x DN20Cu
FP20	LOGI CIVIL	DN25 x 25 Adaptor Bend x PE Compression x Loose Nut



APPENDIX C – SUPPLIER CONTACTS

Austworld Commodities Pty Ltd

2/24 Export Drive

Molendinar QLD 4214

Phone: 1300 780 430

Fax: 1300 780 441

Email: alex.raso@austworld.com.au



Melbourne Office

Level 8, Suite 8.02
401 Docklands Drive
Docklands VIC 3008

Sydney Office

Level 9 420 George Street
Sydney NSW 2000
GPO Box 915
Sydney NSW 2001

P +61 (0) 3 8605 7666
email: info@wsaa.asn.au

www.wsaa.asn.au